

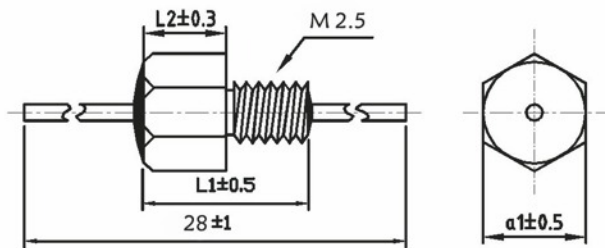

## M2.5 Resin Sealed Bolt-in Feedthrough Capacitors

### Resin Sealed Bolt-in Filters

#### ST2-025 (M2.5, unit: mm)



Lead wire diameter is 0.8mm unless specified otherwise, 0.6mm lead wire is also available  
 Any lead length is available, please ask.  
 Bushing is silver plated brass (Sn plating is also available)

### Specification Data

Part No.	Circuit	Rated Voltage VDC	Rated Current A	Capacitance (nom)	a1 mm	L1 (mm)	L2 (mm)
ST2-02501-X	C	50	10	30000	3.2	6.5	2.5
ST2-02502-X	C	100	10	10000	3.2	6.5	2.5
ST2-02503-X	C	50	10	2200	4	6.5	2.5
ST2-02504-X	C	100	10	1500	4	6.5	2.5
ST2-02505-X	C	50	10	43000	4	6.5	2.5
ST2-02506-X	C	100	10	1800	4	6.5	2.5

Note: All capacitors are multilayer discoidal types

X at the end of the part number signifies the capacitance tolerance required as specified below.

For example ST2-02501-M is a 30000pF with a 20% tolerance.

### Capacitance Tolerance

M	S	Z	H
+20%	+50-20%	+80-20%	+100-0%



# Filtek Solutions

Design, manufacture & sales of EMC components

Capacitance (pF)	Min Insertion Loss (dB)					
	1MHz	10MHz	100MHz	500MHz	1GHz	1.5GHz
1500	*	3	22	28	35	38
2200	*	5	25	30	37	40
10000	2	20	38	45	48	55
18000	6	22	40	45	50	55
30000	8	25	42	48	50	55
43000	13	28	42	48	50	55

Recommended maximum installation torque is 0.15Nm