

## F101A, F101B DC Filters



### Features

- DC filters
- Rated currents from 1A to 50A
- Small size and reliable
- Specially designs for the suppression of the noise on DC power line

### Typical applications

- Electrical and electeic equipment
- Consumer goods
- Industry applications
- Medical equipment

### Technical spcifications

Rated voltage	50/100VDC
Test voltage line to line	3500VDC
Test voltage lime to ground	1414VDC
Insulation resistance	>60 MΩ @60VDC
Temperature rise	<30°C
Climate category (IEC 60068-1)	25/085/21

### Filter selection table

Part No.	Rated Current	Dimension	Terminal		Electeical Schematics
			Input	Output	
F101A-3A-D1	3A	D1			<p>Figure A</p>
F101A-6A-D2	6A	D2			
F101A-10A-D3	10A	D3			
F101A-20A-D5	20A	D5			
F101A-50A-D7	50A	D7			
F101B-1A-D1	1A	D1			<p>Figure B</p>
F101B-3A-D2	3A	D2			
F101B-6A-D4	6A	D4			
F101B-10A-D5	10A	D5			
F101B-20A-D6	20A	D6			
F101B-50A-D7	50A	D7			

## Outline Drawing and Dimensions(mm)

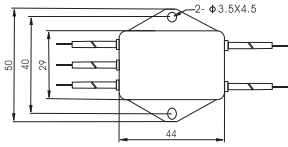

D1

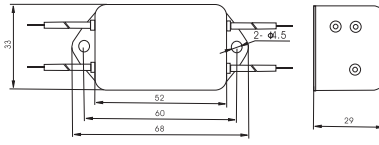

D2

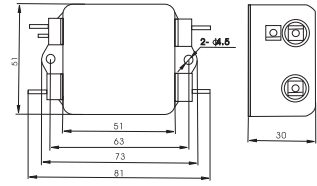

D3

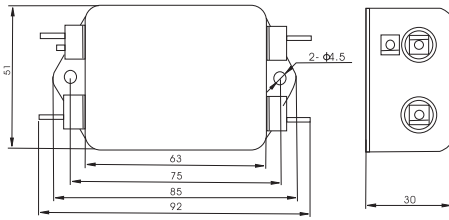

D4

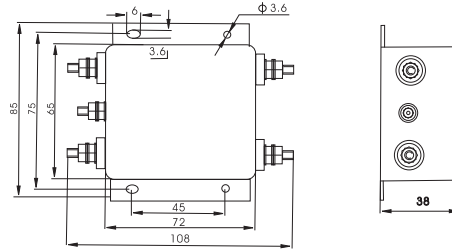

D5

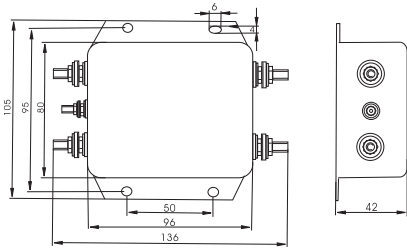

D6

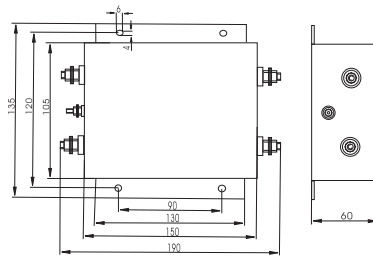

D7

## Insertion Loss

———— Common Mode

----- Differential Mode

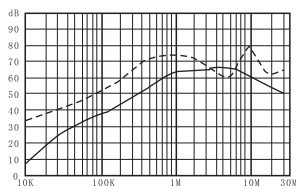

**F101A-3A-D1**

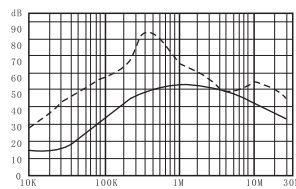

**F101A-6A-D2**

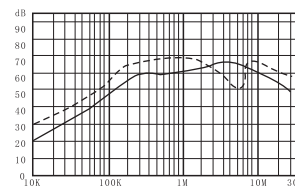

**F101A-10A-D3**

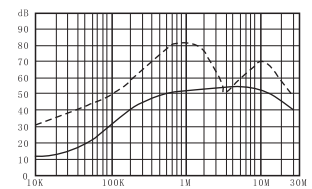

**F101A-20A-D5**

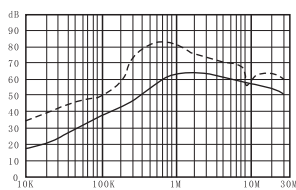

**F101A-50A-D7**

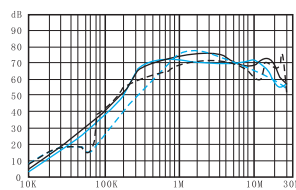

**F101B-1A-B1**

**F101B-3A-D2**

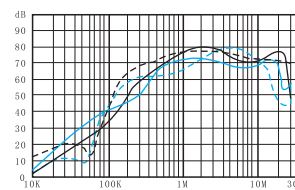

**F101B-6A-D4**

**F101B-10A-D5**

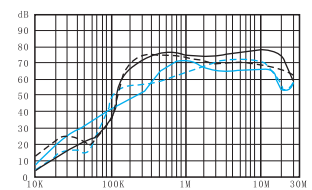

**F101B-20A-D6**

**F101B-50A-D7**