



ST3 Series SMD Feedthrough Capacitors & Pi Filters



Features

- High current SMD filters
- Available in C and Pi versions
- Excellent solderability
- RoHS compliant

Applications

- High current BUS applications
- Digital audio equipment
- Telecommunications

Specifications

Working Voltage	250VDC
Withstanding Voltage	750VDC
Rated Current (max)	20A
Isolation Resistance	$\geq 4000\text{M}\Omega @ 100\text{VDC}$
Dissipation	$< 3,0\%$
Circuit Type	C or Pi
Temperature	-55°C to $+125^{\circ}\text{C}$

Circuit

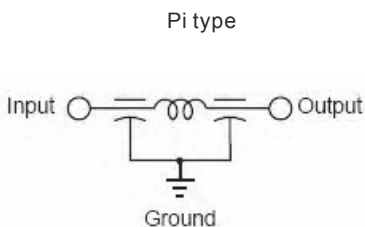
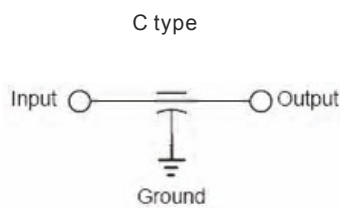

Dimensions

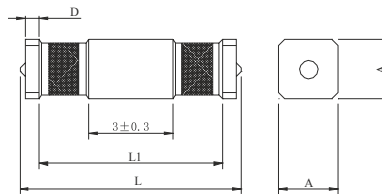

Table 1 Dimensions

Type	L	L1	D	A
ST3-1	8 ± 0.5	6.5 ± 0.3	0.5 ± 0.1	2.2 ± 0.2
ST3-2	8 ± 0.5	6.5 ± 0.3	0.5 ± 0.1	3 ± 0.2
ST3-3	12MAX	10 ± 0.3	0.8 ± 0.1	4 ± 0.2

Table 2 Capacitance Tolerance

M	S	Z	H
+20%	+50-20%	+80-20%	+100-0%



Filtek Solutions

Design, manufacture & sales of EMC components

Order information for C type

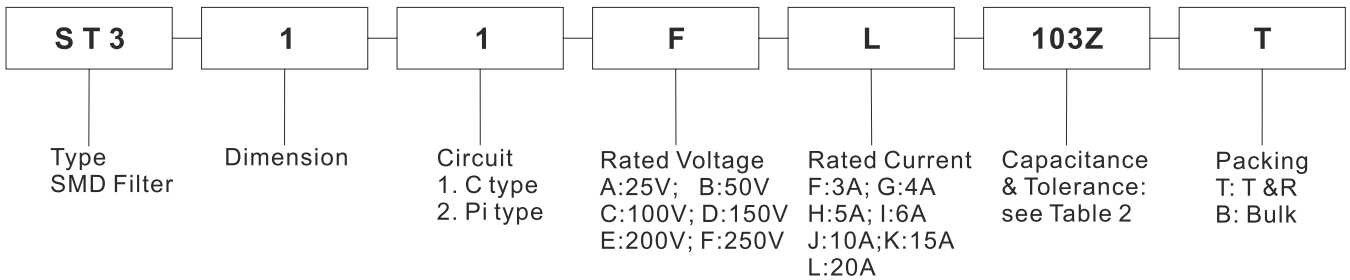

Circuit	Capacitance (pF)	Min insertion loss (dB) 25°C (no load)					
		1 MHz	100 MHz	100 MHz	500 MHz	1 GHz	1.5 GHz
C	68	*	*	*	7	15	20
C	100	*	*	3	10	18	22
C	150	*	8	3	15	20	25
C	200	*	*	3	15	20	25
C	470	*	*	10	15	25	30
C	500	*	*	10	15	25	30
C	1000	*	3	20	25	32	35
C	1500	*	3	22	28	35	38
C	2200	*	5	25	30	37	40
C	2700	*	5	28	35	40	42
C	3300	*	8	30	35	42	45
C	4700	*	10	32	42	45	50
C	6800	1	15	35	42	45	50
C	10000	2	20	38	45	48	55
Pi	68	*	*	*	8	18	22
Pi	100	*	*	3	10	18	22
Pi	150	*	*	5	15	20	25
Pi	200	*	*	5	15	22	26
Pi	470	*	*	12	15	28	32
Pi	500	*	*	12	15	28	35
Pi	1000	*	4	21	26	33	38
Pi	1500	*	4	24	30	36	40
Pi	2200	*	6	26	32	38	40
Pi	2700	*	6	29	36	40	42
Pi	3300	*	9	31	36	42	45
Pi	4700	*	10	32	42	45	50
Pi	6800	1	15	35	43	45	50
Pi	10000	3	20	40	48	50	55

Packing

① Tape & Reel Packing [in Inches (mm)]

② Bulk packing

