

F201A, F201B Single Phase AC Filters



Features

- One-stage filter
- Rated currents from 1A to 100A
- Very high differential and common-mode attenuation
- Type A and Type B
- Easy to install

Typical applications

- Electrical and electronic equipment
- Consumer goods
- Industry applications
- Medical equipment

Technical specifications

Rated voltage	250VAC
Rated frequency	50/60Hz
Test voltage line to line	1500VDC
Test voltage line to ground	1500VDC
Insulation resistance	>50 MΩ @500VDC
Temperature rise	<30°C
Climate category (IEC 60068-1)	25/100/21

Filter selection table

Part No.	Rated Current	Leakage Current	Dimension	Terminal		Electrical Schematics
				Input	Output	
F201A-1A-A1	1A	<0.5mA	A1			<p>Figure A</p>
F201A-3A-A1	3A	<0.5mA	A1			
F201A-6A-A1	6A	<0.5mA	A1			
F201A-10A-A2	10A	<0.5mA	A2			
F201B-6A-A3	6A	<1.0mA	A3			<p>Figure B</p>
F201B-10A-A3	10A	<1.0mA	A3			
F201B-20A-A4	20A	<1.0mA	A4			
F201B-30A-A4	30A	<1.0mA	A4			
F201B-20A-A5	20A	<1.0mA	A5			
F201B-30A-A5	30A	<1.0mA	A5			
F201B-50A-A6	50A	<2.0mA	A6			
F201B-100A-A7	100A	<2.0mA	A7			

Outline Drawing and Dimensions(mm)

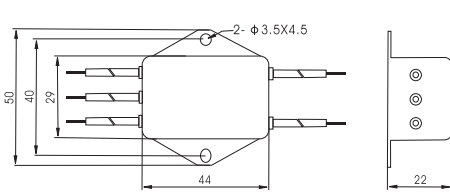

A1

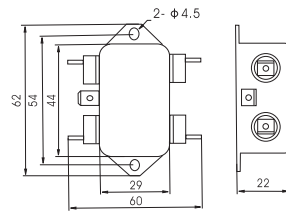

A2

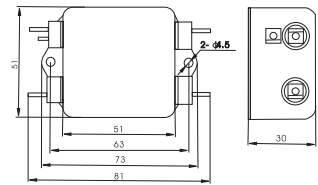

A3

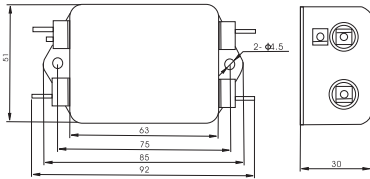

A4

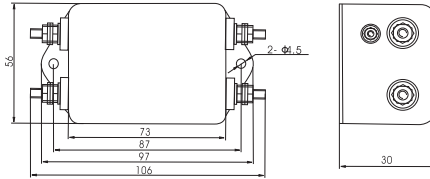

A5

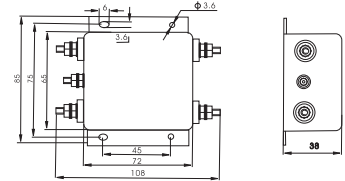

A6

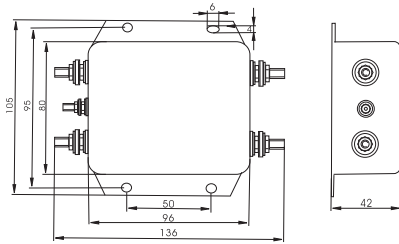

A7

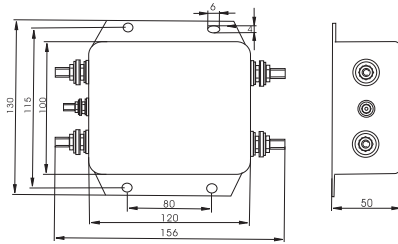

A8

Insertion Loss

—— Common Mode

----- Differential Mode

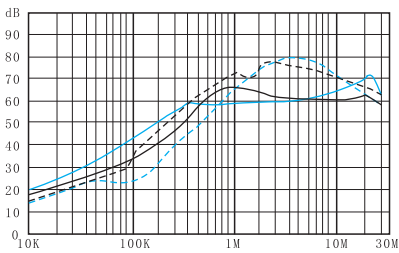

F201A-1A-A1, F201A-3A-A1

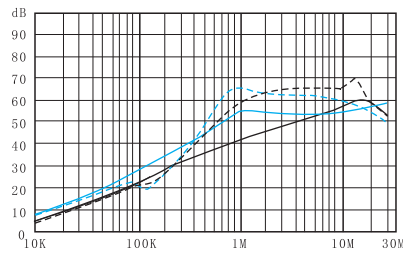

F201A-6A-A1, F201A-10A-A2

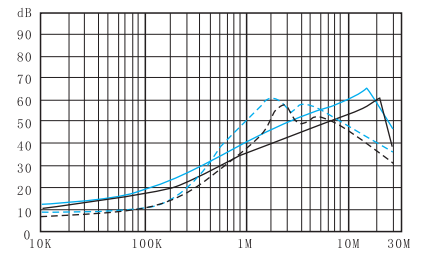

F201B-6A-A3, F201B-10A-A3

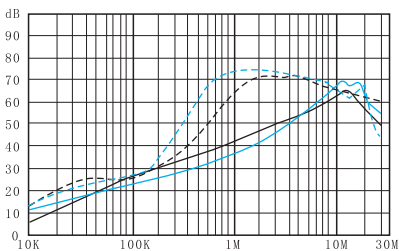

F201B-20A-A4, F201B-30A-A5

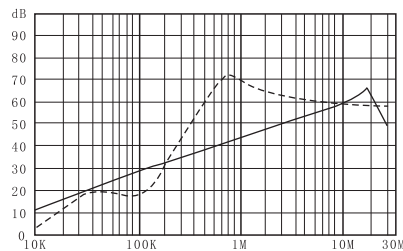

F201B-50A-A6

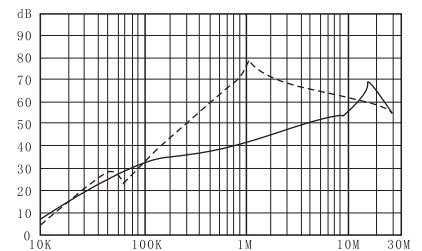

F201B-100A-A7